

Power Trim Manual Release Valve Tip Breakage – 35 thru 125

MARINER/ MERCURY SINGLE RAM POWER TRIM

Power Trim Date Code 13236 and Below

1989 thru 1995 35-125 h/p

U.S.

S/N 0C159200 thru 0G024085

Belgium

S/N 09570305 thru 09805370

Single ram trim units that incorporate a **black** manual release valve, may have a tendency to break off the valve tip in the trim pump manifold assembly. The tip and o-ring usually remains lodged in the manifold assembly. Tip breakage is caused by a tight tolerance between the manual release valve and the manifold assembly bore.

SYMPTOM:

The trim unit will not be able to be raised or lowered manually by unscrewing the manual release valve, three (3) turns maximum counterclockwise (Figure 1).

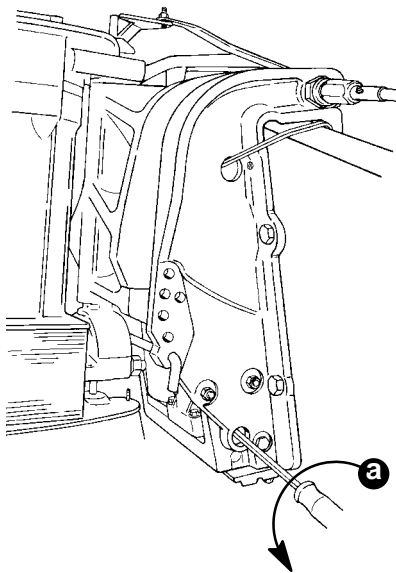

52028

a - Three (3) turns counterclockwise

Figure 1. Manual Release Valve Location

⚠ CAUTION

When removing the trim/tilt assembly, be sure to support the outboard in the “up” position.

CORRECTION:

Remove the trim/tilt assembly from between the clamp brackets as outlined in the appropriate service manual. With the assembly removed, disassemble the trim/tilt cylinder from the manifold assembly. While the manifold assembly is separated from the trim/tilt cylinder, carefully insert a .060 inch (15 mm) diameter, and minimum of 4 inches (100 mm) long steel rod through the oil passage hole (Figure 2) of the manifold assembly and push (press) out the broken tip.

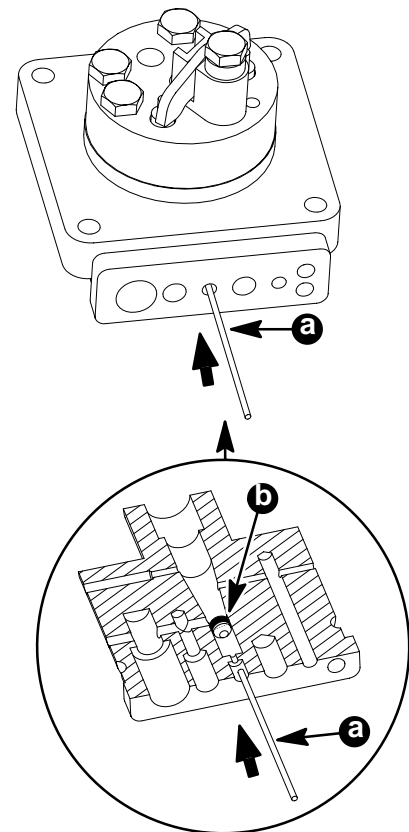

a - .060 inch (15 mm) Rod

b - Broken Manual Release Valve Tip

Figure 2. Manifold Assembly

After the removal of the broken tip, install a new **white** manual release valve with o-rings, part number 813442A 2, and tighten. If required, install a new seal kit. Refer to the proper parts manual for seal kit and service manual for reassembly instructions. Reassemble trim/tilt cylinder to the manifold assembly.

Cleanliness must be taken into consideration when working with hydraulics. Be sure the work area is free from dirt and debris.

FACTORY CORRECTION:

Starting with S/N 0G024085 (USA), 09805370 (Belgium) and power trim date code 13237 and above, the manual release valve will be **white** in color.

WARRANTY:

For units within the serial numbers listed and under the warranty period, submit a completed warranty claim.

Qty. 1

P/N 813442A 2 Manual Release Valve Assembly
 (white)

If required, seal kit.

One and One tenth (1.1) hour labor.

Warranty Labor Rate Code: OH40

Failure Code: 123 07