

Circulate to: Sales Manager Accounting Service Manager Technician Parts Manager

Transom Bolt Torque/Engine Mounting

Revised September 2007. This bulletin supersedes the previous bulletin number 2005-12, issued October 2005.

Model Affected

All outboards 8 HP and above.

Situation

An engine mounting bolt/nut torque is recommended to ensure that engines remain secure on the transom. The transom mounting bolts/nuts should be able to hold the recommended torque of the fasteners listed below without the transom yielding or cracking. If the transom yields or cracks under the torque of the transom bolts/nuts, the transom must be strengthened or the load carrying area increased. Always use manufacturer supplied fasteners.

8/9.9 FourStroke non-power trim engine with 1/4" bolt	7 lb. ft.
8/9.9 FourStroke power trim models with M8 bolt	10 lb. ft.
15 FourStroke with 5/16" bolt	25 lb. ft.
25 EFI FourStroke with M8 bolt	10 lb. ft.
25/30 EFI FourStroke with M12 bolt	52 lb. ft.
Outboards 40 and above with 1/2" bolt	55 lb. ft.

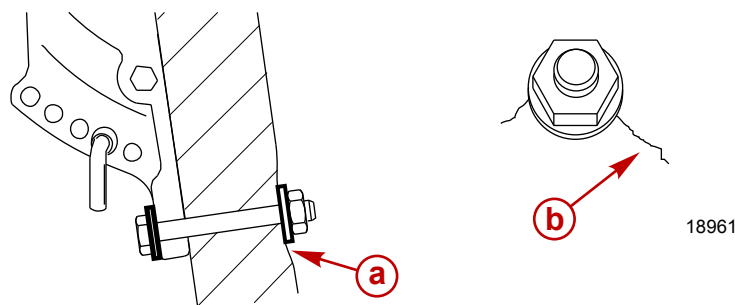

- a - Transom yielding under bolt torque
- b - Transom cracking under bolt torque

NOTE: When first determining transom strength, use a dial type torque wrench. If the bolt or nut continues to turn without the torque reading on the dial increasing, it is an indication that the transom is yielding.

THE INFORMATION IN THIS DOCUMENT IS CONFIDENTIAL AND PROTECTED BY COPYRIGHT AND IS THE PROPERTY OF MERCURY MARINE.

This document is provided for the sole and exclusive use of the original recipient as prescribed by Mercury Marine and may not be distributed or copied, digitally or otherwise, without the prior written consent of Mercury Marine.

The load carrying area can be increased by using a larger washer or a transom reinforcement plate.

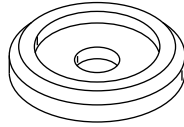

30513

Larger transom washer P/N 67-896392



30511

P/N 67-896305

The transom reinforcement plate can be used on outboards 40 HP and above.

NOTE: For a more accurate torque, whenever possible, turn/tighten mounting nut rather than turning the bolt.

THE INFORMATION IN THIS DOCUMENT IS CONFIDENTIAL AND PROTECTED BY COPYRIGHT AND IS THE PROPERTY OF MERCURY MARINE.

This document is provided for the sole and exclusive use of the original recipient as prescribed by Mercury Marine and may not be distributed or copied, digitally or otherwise, without the prior written consent of Mercury Marine.