

TO: SERVICE MANAGER MECHANICS
PARTS MANAGER

REVISED
4-21-86

No. 86-6

- A. MC-I Drive Unit Gasket Kits
B. Alpha One Gear Ratio

A. MC-I DRIVE UNIT GASKET KITS

The drive unit gasket for the various MerCruiser I models will now be offered as part of a kit including the bell housing sealing ring, water passage "O" ring and U-joint shaft "O" rings. (Examples shown below) The kits will be sold under the original gasket part number followed by an A1. Refer to the parts manual for correct gasket part number for the unit being serviced. The gaskets will no longer be offered individually and will be superseded as follows.

27-32599A1 supersedes 27-32599
27-33507A1 supersedes 27-33507
27-33796A1 supersedes 27-33796
27-35996A1 supersedes 27-35996
27-64818A1 supersedes 27-64818
27-94996A1 supersedes 27-94996

Following are two samples of what the kits will consist of:

27-94996A1

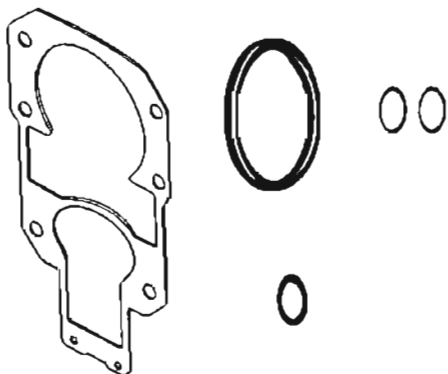

27-64818A1

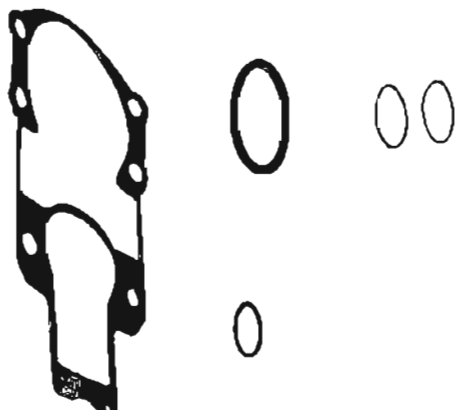

B. Alpha One GEAR RATIO

The 1986 Alpha One engine models (listed on the chart) following, may be shipped from a boat manufacturer with any of the ratios listed below.

In certain, rare cases, MerCruiser has approved the use of a drive unit without the standard gear ratio. The boat manufacturer was able to increase performance without jeopardy to drive unit durability. MerCruiser specifically does not recommend use of other than the standard drive unit on other than approved boats.

Model	Standard Gear Ratio	Optional Sea Level Gear Ratio	Optional High Elevation Gear Ratio
MCM 120	1.98:1	N/A	N/A
MCM 140	1.98:1	N/A	N/A
MCM 170	1.84:1	*1.98:1/1.65:1	1.98:1
MCM 190	1.84:1	*1.98:1/1.65:1	1.98:1
MCM 185	1.84:1	1.65:1	1.98:1
MCM 205	1.84:1	1.65:1	1.98:1
MCM 200	1.65:1	*1.50:1	1.8:1
MCM 230	1.50:1	N/A	1.65:1/1.84:1
MCM 260	1.50:1	N/A	1.65:1/1.84:1
MCM 300 Tempest	1.50:1	N/A	N/A
MCM 350 Magnum	1.50:1	N/A	N/A
MCM 454 Magnum	1.32:1	N/A	N/A

Note: N/A - Not Available

*Optional ratio on some boats approved by Mercury Marine